

**NAPLES RESERVE
COMMUNITY DEVELOPMENT
DISTRICT**

October 14, 2021

BOARD OF SUPERVISORS

WORKSHOP AGENDA

Naples Reserve Community Development District

OFFICE OF THE DISTRICT MANAGER

2300 Glades Road, Suite 410W • Boca Raton, Florida 33431

Phone: (561) 571-0010 • Toll-free: (877) 276-0889 • Fax: (561) 571-0013

October 7, 2021

Board of Supervisors
Naples Reserve Community Development District

ATTENDEES:
Please identify yourself each time you speak to facilitate accurate transcription of meeting minutes.

Dear Board Members:

The Board of Supervisors of the Naples Reserve Community Development District will hold a Workshop on October 14, 2021, at 10:30 a.m., at the Island Club at Naples Reserve, Activities Room, 14885 Naples Reserve Circle, Naples, Florida 34114, or remotely, via Zoom, at <https://zoom.us/j/93710553245?pwd=L2xyZTBXLzVIM0NESVNoUHhGTFQzd09>, Meeting ID: **937 1055 3245** or via Phone at **1-929-205-6099**, Meeting ID: **937 1055 3245**, Passcode: **521802**. The agenda is as follows:

1. Call to Order/Roll Call
2. Chairman's Opening Remarks
3. Discussion: CDD Bonds
 - Public Comments
4. Discussion: CDD Background
 - Public Comments
5. Discussion: Repairs and Maintenance of CDD Improvements
 - Public Comments
6. Public Comments: *non-agenda items*
7. NEXT MEETING DATE: December 2, 2021 at 10:30 AM
 - QUORUM CHECK

CHARLENE HILL	<input type="checkbox"/> IN PERSON	<input type="checkbox"/> PHONE	<input type="checkbox"/> NO
THOMAS MARQUARDT	<input type="checkbox"/> IN PERSON	<input type="checkbox"/> PHONE	<input type="checkbox"/> NO
DEBORAH LEE GODFREY	<input type="checkbox"/> IN PERSON	<input type="checkbox"/> PHONE	<input type="checkbox"/> NO
GREGORY INEZ	<input type="checkbox"/> IN PERSON	<input type="checkbox"/> PHONE	<input type="checkbox"/> NO
	<input type="checkbox"/> IN PERSON	<input type="checkbox"/> PHONE	<input type="checkbox"/> NO

8. Supervisors' Requests

9. Adjournment

Should you have any questions and/or concerns, please feel free to contact me directly at (561) 346-5294.

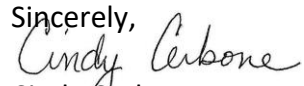
Sincerely,

Cindy Cerbone
District Manager

**NAPLES RESERVE
COMMUNITY DEVELOPMENT DISTRICT**

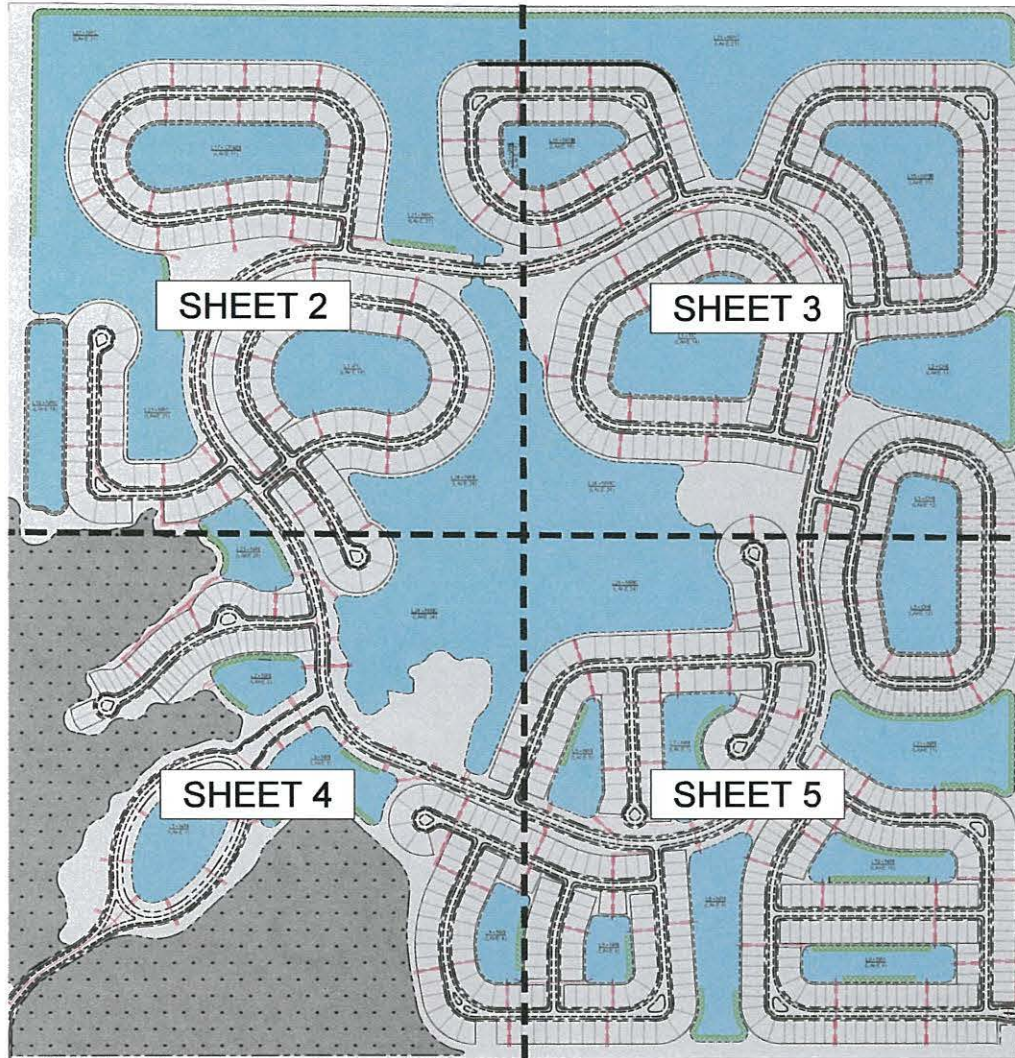
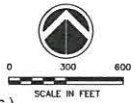
5



LAKE	AREA (Ac.)	LAKE LITTORAL AREA (Ac.)
1	5.5	
2	2.7	.46
3	4.6	.79
4	2.6	.23
5	2.6	.23
6	1.9	.16
7	4.1	.42
8	6.1	.53
9	3.5	1.28 .68
10	3.2	.74
11	9.1	
12	7.5	
13	8.8	.54
14	9.2	
15	7.5	
16	3.5	
17	6.7	
18	4.0	
19	7.0	
20	61.1	5.00 .35
21	50.0	
24		
TOTAL	214.4	11.41

NOTES:

- ALL LAKES, STORMWATER MANAGEMENT PIPING AND PRESERVE SHALL BE MAINTAINED BY THE NAPLES RESERVE HOMEOWNERS ASSOCIATION, INC.
- THE DEVELOPMENT IS ZONED 'RPUD'.

LEGEND

L21 - NRC = LAKE # PER PLAT
(LAKE 21) = (ORIGINAL LAKE #)

- COMMUNITY DEVELOPMENT DISTRICT LANDS
- LAKE TRACTS CONVEYED TO CDD
- PRESERVE TRACTS MAINTAINED BY HOA
- DRAINAGE EASEMENTS AND PIPES MAINTAINED BY CDD
- LAKE LITTORAL AREA

LETTER	REVISIONS	DATE

NAPLES RESERVE

DESIGNED BY W.W.B.	DATE 2/21
DRAWN BY W.W.B.	DATE 2/21
CHECKED BY W.T.C.	DATE 2/21
VERTICAL SCALE 1"=1'	HORIZONTAL SCALE 1"=300'



950 Encore Way
Naples, FL 34110
Phone: (239) 254-2000
Florida Certificate of
Authorization No.1772

**CDD DRAINAGE EASEMENTS
and LAKE CONVEYANCE MAPS**

THESE DRAWINGS ARE NOT APPROVED FOR CONSTRUCTION UNLESS SIGNED BELOW:	REFERENCE NO. SEE PLOTSTAMP	DRAWING NO. 5008-1
DATE: _____	PROJECT NO. 2013.030	SHEET NO. 1 OF 5

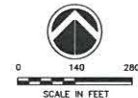

LEGEND

L21 - NRC = LAKE # PER PLAT
 (LAKE 21) = (ORIGINAL LAKE #)

- COMMUNITY DEVELOPMENT DISTRICT LANDS
- LAKE TRACTS CONVEYED TO CDD
- PRESERVE TRACTS MAINTAINED BY HOA
- DRAINAGE EASEMENTS AND PIPES MAINTAINED BY CDD
- LAKE LITTORAL AREA

PLAT	REFERENCE
C.H.I	CORAL HARBOR PHASE I
C.P. & B.I.	CRANE POINT & BIMINI ISLE
N.R.C.	NAPLES RESERVE CIRCLE
N.R.I.C.	NAPLES RESERVE ISLAND CLUB
N.R.I	NAPLES RESERVE PHASE I
N.R.II	NAPLES RESERVE PHASE II
N.R.III	NAPLES RESERVE PHASE III
P.C.	PARROT CAY
S.C.	SUTTON CAY

NOTES:

1. ALL LAKES, STORMWATER MANAGEMENT PIPING AND PRESERVE SHALL BE MAINTAINED BY THE NAPLES RESERVE HOMEOWNERS ASSOCIATION, INC.
2. THE DEVELOPMENT IS ZONED 'RPUD'.



MATCHLINE - SEE SHEET 3

MATCHLINE - SEE SHEET 4

LETTER	REVISIONS	DATE

NAPLES RESERVE

DESIGNED BY W.W.B.	DATE 2/21
DRAWN BY W.W.B.	DATE 2/21
CHECKED BY W.T.C.	DATE 2/21
VERTICAL SCALE N/A	HORIZONTAL SCALE 1"=140'



950 Encore Way
 Naples, FL 34110
 Phone: (239) 254-2000
 Florida Certificate of
 Authorization No.1772

**CDD DRAINAGE EASEMENTS
 and LAKE CONVEYANCE MAPS**

THESE DRAWINGS ARE NOT
 APPROVED FOR CONSTRUCTION
 UNLESS SIGNED BELOW:
 DATE: _____

REFERENCE NO. SEE PLOTSTAMP	DRAWING NO. 2005-02
PROJECT NO. 2013.030	SHEET NO. 2 OF 5

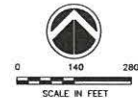

LEGEND

L21 - NRC = LAKE # PER PLAT
 (LAKE 21) = (ORIGINAL LAKE #)

- COMMUNITY DEVELOPMENT DISTRICT LANDS
- LAKE TRACTS CONVEYED TO CDD
- PRESERVE TRACTS MAINTAINED BY HOA
- DRAINAGE EASEMENTS AND PIPES MAINTAINED BY CDD
- LAKE LITTORAL AREA

PLAT	REFERENCE
C.H.I	CORAL HARBOR PHASE I
C.P.&B.I.	CRANE POINT & BIMINI ISLE
N.R.C.	NAPLES RESERVE CIRCLE
N.R.I.C.	NAPLES RESERVE ISLAND CLUB
N.R.I	NAPLES RESERVE PHASE I
N.R.II	NAPLES RESERVE PHASE II
N.R.III	
P.C.	PARROT CAY
S.C.	SUTTON CAY

NOTES:

1. ALL LAKES, STORMWATER MANAGEMENT PIPING AND PRESERVE SHALL BE MAINTAINED BY THE NAPLES RESERVE HOMEOWNERS ASSOCIATION, INC.
2. THE DEVELOPMENT IS ZONED 'RPUD'.

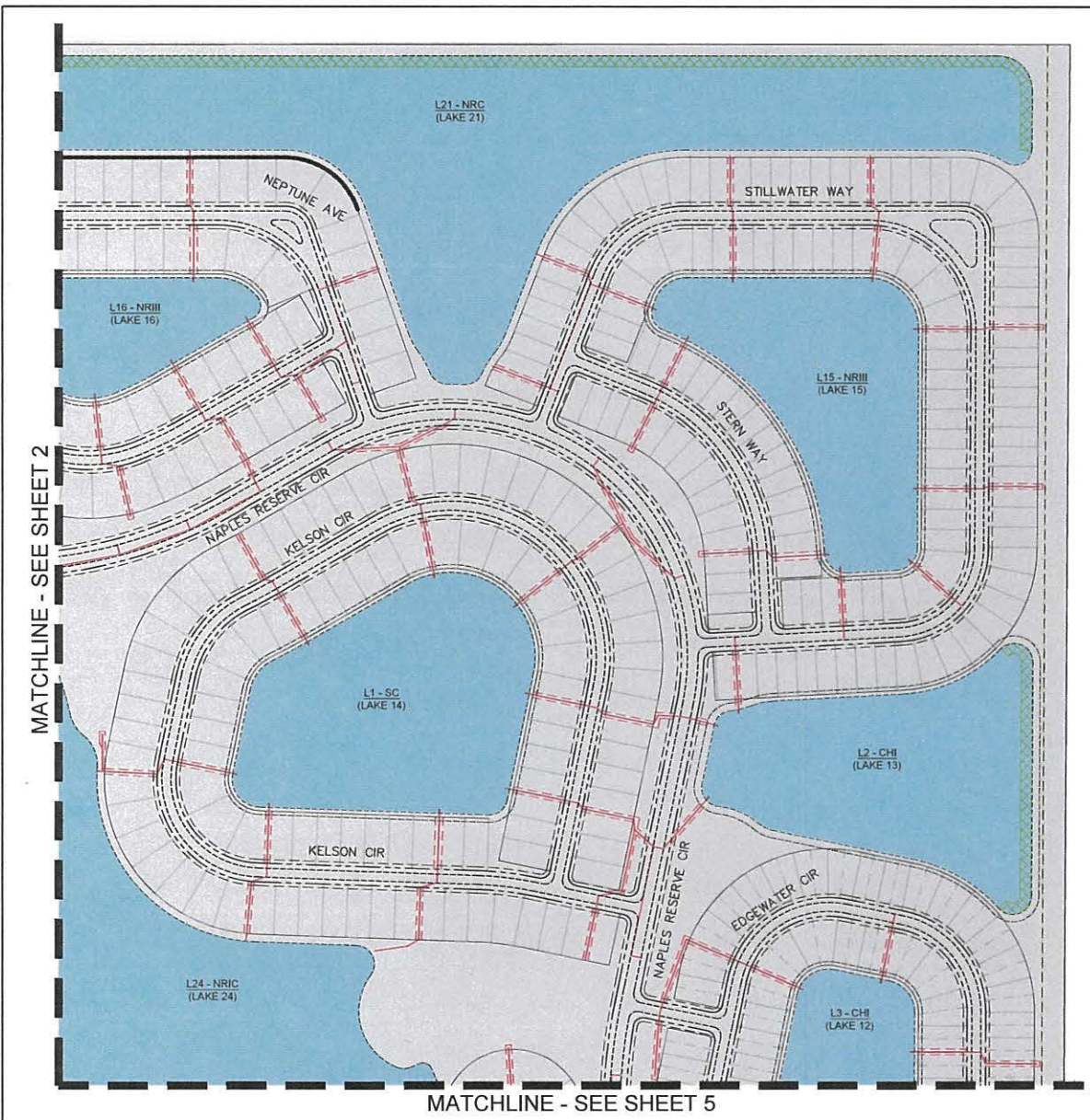

MATCHLINE - SEE SHEET 2

MATCHLINE - SEE SHEET 5

NAPLES RESERVE

DESIGNED BY W.W.B.	DATE 2/21
DRAWN BY W.W.B.	DATE 2/21
CHECKED BY W.T.C.	DATE 2/21
VERTICAL SCALE N/A	HORIZONTAL SCALE 1"=140'



950 Encore Way
 Naples, FL 34110
 Phone: (239) 254-2000
 Florida Certificate of
 Authorization No.1772

**CDD DRAINAGE EASEMENTS
 and LAKE CONVEYANCE MAPS**

THESE DRAWINGS ARE NOT APPROVED FOR CONSTRUCTION UNLESS SIGNED BELOW:	REFERENCE NO.	DRAWING NO.
	SEE PLOTSTAMP	5008-3
PROJECT NO.	SHEET NO.	
2013.030	3 OF 5	
DATE		

LETTER	REVISIONS	DATE

MATCHLINE - SEE SHEET 2

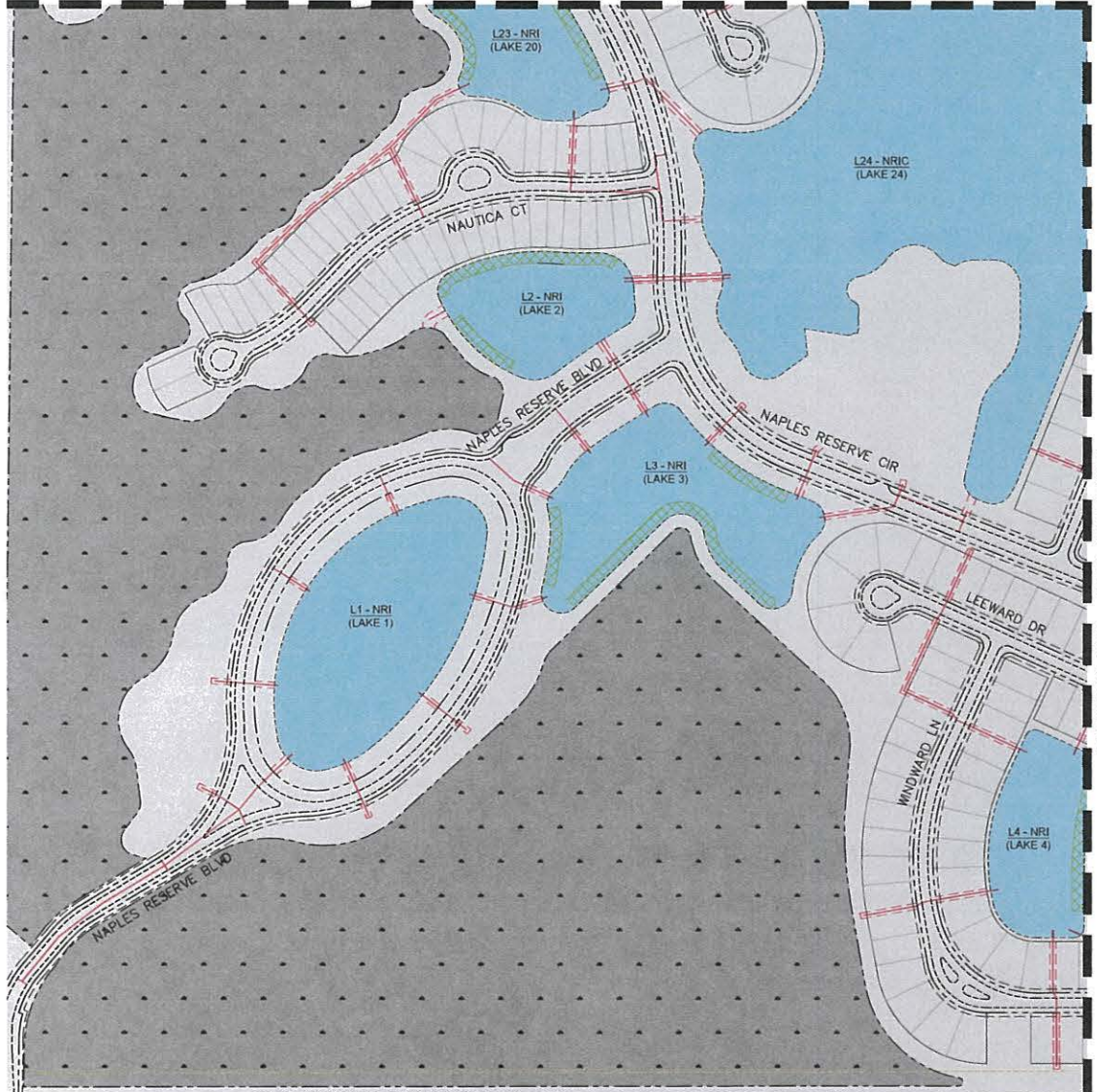
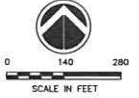

MATCHLINE - SEE SHEET 5

LEGEND

L21 - NRC = LAKE # PER PLAT
 (LAKE 21) = (ORIGINAL LAKE #)

- COMMUNITY DEVELOPMENT DISTRICT LANDS
- LAKE TRACTS CONVEYED TO CDD
- PRESERVE TRACTS MAINTAINED BY HOA
- DRAINAGE EASEMENTS AND PIPES MAINTAINED BY CDD
- LAKE LITTORAL AREA

PLAT	REFERENCE
C.H.I	CORAL HARBOR PHASE I
C.P.& B.I.	CRANE POINT & BIMINI ISLE
N.R.C.	NAPLES RESERVE CIRCLE
N.R.I.C.	NAPLES RESERVE ISLAND CLUB
N.R.I	NAPLES RESERVE PHASE I
N.R.II	NAPLES RESERVE PHASE II
N.R.III	
P.C.	PARROT CAY
S.C.	SUTTON CAY

NOTES:

1. ALL LAKES, STORMWATER MANAGEMENT PIPING AND PRESERVE SHALL BE MAINTAINED BY THE NAPLES RESERVE HOMEOWNERS ASSOCIATION, INC.
2. THE DEVELOPMENT IS ZONED 'RPUD'.

ALL INFORMATION ON THIS DRAWING IS THE PROPERTY OF HOLE MONTES ENGINEERING, INC. NO PART OF THIS DRAWING IS TO BE REPRODUCED OR TRANSMITTED IN ANY FORM OR BY ANY MEANS, ELECTRONIC OR MECHANICAL, INCLUDING PHOTOCOPYING, RECORDING, OR BY ANY INFORMATION STORAGE AND RETRIEVAL SYSTEM, WITHOUT THE WRITTEN PERMISSION OF HOLE MONTES ENGINEERING, INC.

LETTER	REVISIONS	DATE

NAPLES RESERVE

DESIGNED BY W.W.B.	DATE 2/21
DRAWN BY W.W.B.	DATE 2/21
CHECKED BY W.T.C.	DATE 2/21
VERTICAL SCALE N/A	HORIZONTAL SCALE 1"=140'



950 Encore Way
 Naples, FL 34110
 Phone: (239) 254-2000
 Florida Certificate of
 Authorization No. 1772

**CDD DRAINAGE EASEMENTS
 and LAKE CONVEYANCE MAPS**

THESE DRAWINGS ARE NOT APPROVED FOR CONSTRUCTION UNLESS SIGNED BELOW:	REFERENCE NO. SEE PLOTSTAMP	DRAWING NO. 5008-04
DATE	PROJECT NO. 2013.030	SHEET NO. 4 OF 5

MATCHLINE - SEE SHEET 3

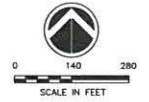

MATCHLINE - SEE SHEET 4

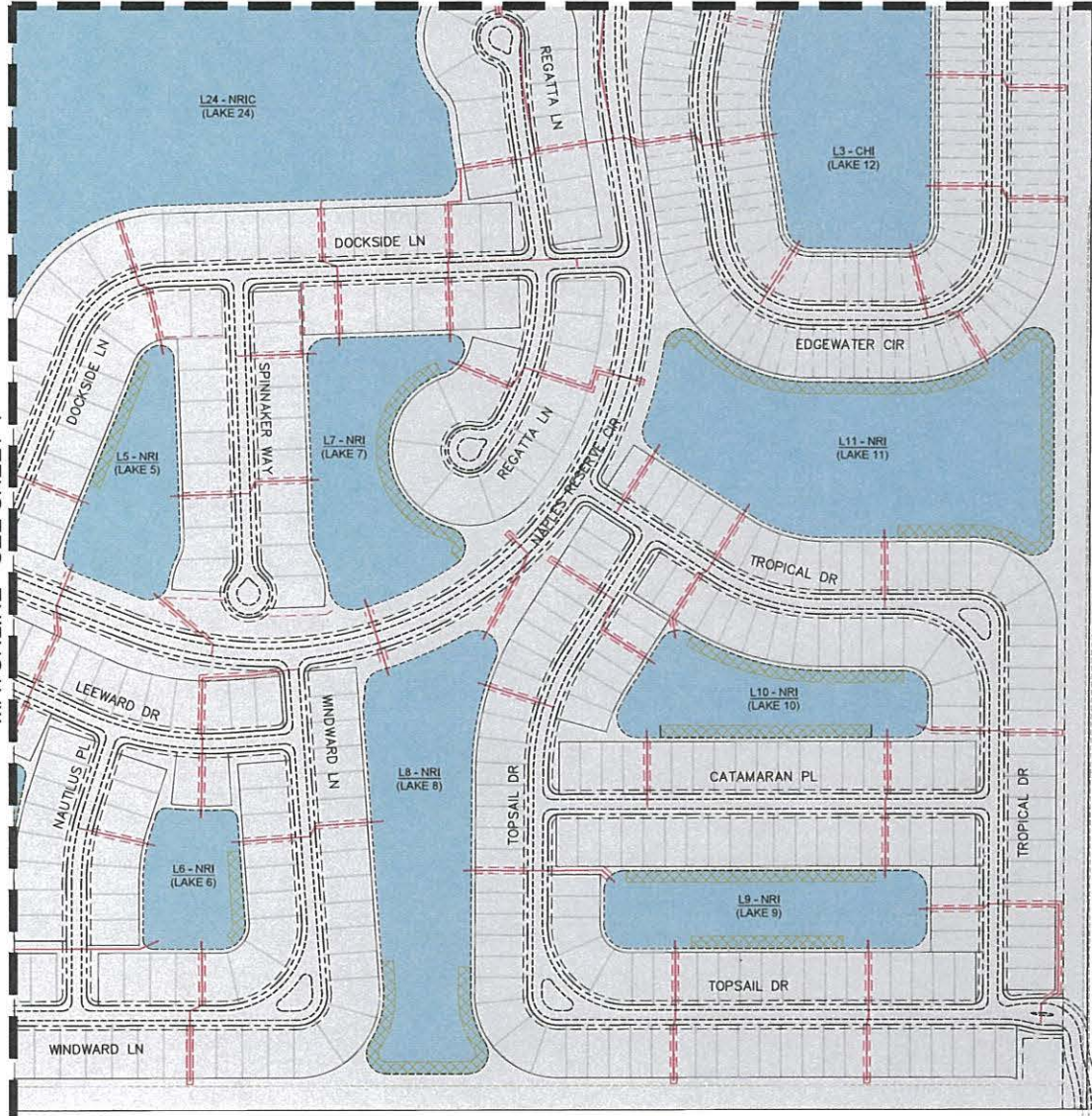

LEGEND

L21 - NRC = LAKE # PER PLAT
(LAKE 21) = (ORIGINAL LAKE #)

- COMMUNITY DEVELOPMENT DISTRICT LANDS
- LAKE TRACTS CONVEYED TO CDD
- PRESERVE TRACTS MAINTAINED BY HOA
- DRAINAGE EASEMENTS AND PIPES MAINTAINED BY CDD
- LAKE LITTORAL AREA

PLAT	REFERENCE
C.H.I	CORAL HARBOR PHASE I
C.P. & B.I.	CRANE POINT & BIMINI ISLE
N.R.C.	NAPLES RESERVE CIRCLE
N.R.I.C.	NAPLES RESERVE ISLAND CLUB
N.R.I	NAPLES RESERVE PHASE I
N.R.II	NAPLES RESERVE PHASE II
N.R.III	
P.C.	PARROT CAY
S.C.	SUTTON CAY

NOTES:

1. ALL LAKES, STORMWATER MANAGEMENT PIPING AND PRESERVE SHALL BE MAINTAINED BY THE NAPLES RESERVE HOMEOWNERS ASSOCIATION, INC.
2. THE DEVELOPMENT IS ZONED 'RPUD'.

LETTER	REVISIONS	DATE

NAPLES RESERVE

DESIGNED BY W.W.B.	DATE 2/21
DRAWN BY W.W.B.	DATE 2/21
CHECKED BY W.T.C.	DATE 2/21
VERTICAL SCALE N/A	HORIZONTAL SCALE 1"=140'



950 Encore Way
Naples, FL 34110
Phone: (239) 254-2000
Florida Certificate of
Authorization No.1772

**CDD DRAINAGE EASEMENTS
and LAKE CONVEYANCE MAPS**

THESE DRAWINGS ARE NOT APPROVED FOR CONSTRUCTION UNLESS SIGNED BELOW	REFERENCE NO. SEE PLOT/STAMP	DRAWING NO. 5008-5
DATE	2013.030	SHEET NO. 5 OF 5